

TUI BREWERY

FUNCTIONS & CONFERENCE VENUE



Tui Brewery
State Highway 2
Mangatainoka

CONTENTS

Introduction	4
Tui's Awesome Spaces	6
• The Flagon Room	6
• Tui HQ Tap Room & Kitchen	7
• Tuiversity	8
Breakout Activities	9
• At Tui Brewery	9
• In the Area	10
Package Deals	11
• Brewer & Vinter Experience	11
Catering Options	12
Package Deals Extras	13
Getting Here / Accommodation	14





INTRODUCTION TO TUI BREWERY

The Brewery has been around in one form or another since Henry Wagstaff first set up shop on the banks of the Mangatainoka River in 1889. In 1903 he sold it to Henry Cowan, who developed the prize-winning East India Pale Ale, and as the factory expanded, a seven-storey brew tower was built in 1931, so brewers could use gravity to turn malt into beer. Strangely, the builders forgot to put in a lift and stairs, and this quirk has only added intrigue to the site's long history. The tower is now classified as a Category 1 Heritage Listed building and has been earthquake strengthened.

In 1969 the Brewery was sold to Dominion Breweries, which expanded the business outside its traditional catchments of Wairarapa and Hawke's Bay. Then in the nineties with a new brand and new brew, a humorous 'yeah right' marketing campaign helped spread Tui's reach nationwide. The campaign was such a huge success that "yeah right" became part of the Kiwi vernacular. It also saw visitor numbers soar at Tui with 50,000 visitors making the annual pilgrimage to see what all the fuss was about.

These days, DB still oversee all brewing activities on site and in 2016 a new state of the art brewery was built, allowing Tupu, our head brewer, to hand craft six varieties of beers in small batches,



allowing time for their flavours to fully develop. A special feature of this brewery is the ability to create personalised beer labels meaning visitors can take home something special from their time here.

Our popular kitchen and bar offers a menu inspired by wholesome, fresh local produce and bounties from the sea and land; our brewery tours, retail store as well as functions and events. Because there is a range of great indoor and outdoor spaces that can be reserved for your convenience, Tui Brewery is an all-weather destination.

"With over 129 years of brewing experience on site, Tui Brewery has a proud and rich history. Now, thanks to recent upgrades and refurbishments Tui will be standing proud on the banks of the Mangatainoka river for another 129 years. Come and experience it yourself."



VOTED BY THE CORPORATE EVENTS GUIDE AS NEW ZEALAND'S BEST “PRIVATE FUNCTION VENUE”, TUI BREWERY OFFERS A RELAXED ENVIRONMENT WITH ALL THE MOD-CONS YOU'D EXPECT IN THE BIG SMOKE.

Centrally located in a rural setting in the lower North Island, we cater for groups up to 250 people and offer three conference rooms, a variety of onsite and off-site activities; three different group experiences as well as Brewery Tours and beer tasting experiences. In addition we offer a variety of terrific, honest and fresh menu options while our experienced Event Management Team and Function Liaison will help make your conference, event or function one to remember.

The following pages are a guideline to help assist you with your planning. However at any time you wish, our Event Management Team are available to talk to you on the phone. Even better... don't take our word for it. Come and see for yourself. Book a site visit and meet the team.

Contact our team:
hospo@tuihq.co.nz
or ring 06 376 0815 / 021 228 8447

NB – All prices quoted are subject to change



TUI'S AWESOME SPACES



The Flagon Room

The brewery's original brick flagon room with exposed timber beams has been revamped into a stunning function room. With seating for 175 people, or up to 220 people cocktail style, this room looks great in its original style or can be transformed into a themed setting with fairy lights or colourful table decorations.

Cosy wood-fired heating makes it ideal for winter while the wide veranda offers guests views out towards the iconic seven-storey Tui Tower, the garden bar and state of the art brewery. There is also a private tap bar and private buffet area.

Available seven days a week 11am-12am.

Cost from \$1,500

For up to 7 hours, and \$100 per hour over 7. Minimum 80 people.

Price includes use of our free WiFi, microphone and a function host to assist with your function planning and delivery.



COVERED DECK

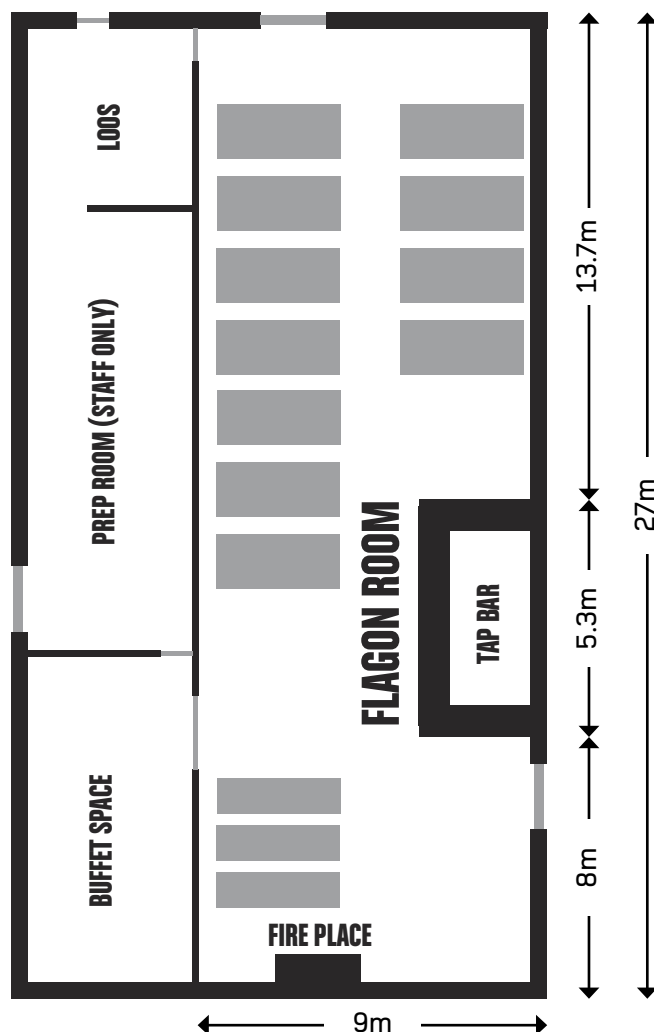

Total floor area of 243m² (Map not to scale)



TUI'S AWESOME SPACES



Tui HQ Tap Room & Kitchen

Home to all things Tui and located in our original headquarters, the Tap Room has a rustic, laid back atmosphere. A large wood burner keeps things cosy in the winter while large bi-fold doors and veranda lead outside to our large garden bar and "village green".

The Tap Room has indoor seating for 70 people across two stories, but can accommodate up to 250 people when the sun is shining and the garden bar is utilised.

Available seven days a week from closing (for private bookings) to 12am.

Cost from \$500

For 7 hours, which includes use of our free WiFi, microphone, speakers.



WiFi



Off Road Parking



Microphone

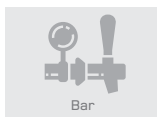

Bar



Tables & Chairs

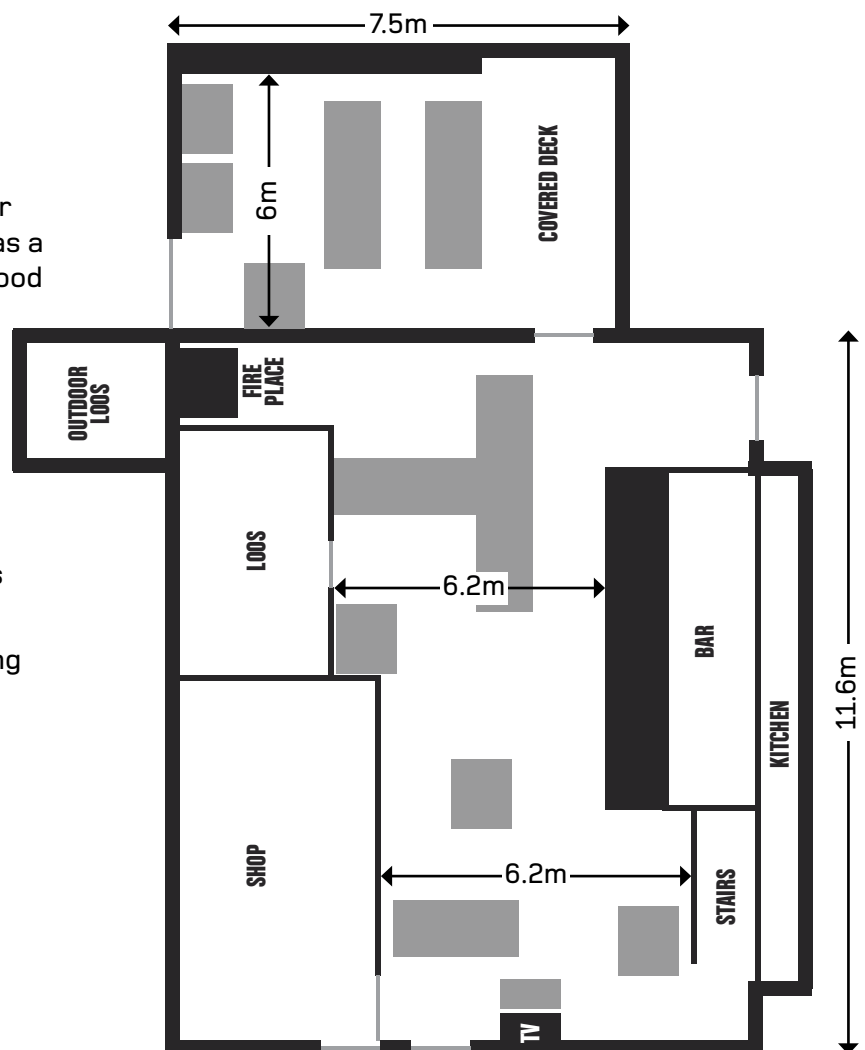

(Map not to scale)



TUI'S AWESOME SPACES



Tuiversity

Tuiversity is our seat of learning, where knowledge reigns supreme and ideas are born. This purpose built conference facility has two distinct rooms each that can access the long veranda which affords visitors with views over the garden bar to the brewery and iconic Tui Tower. There is also plenty of space for breakout and team building activities.

Brewer's Boardroom

Suitable for meetings for up to 14 people. \$50 for up to 7 hours and \$50 per hour over 7 hours.

Cost from \$50

The Conference Room

which can be set out in different ways.

1. Boardroom style (30 people capacity)
 2. Classroom style (20 people capacity)
 3. Theatre style (40 people capacity)
 4. Cabaret style (49 people capacity)
- Table hire required

Cost from \$250

Suitable for meetings up to 49 people. Cost \$250 for up to 7 hours and \$100 per hour over 7 hours. Both spaces are available 7 days a week from 9am-5pm and include use of our free WiFi, white board, markers, chilled water and mints.

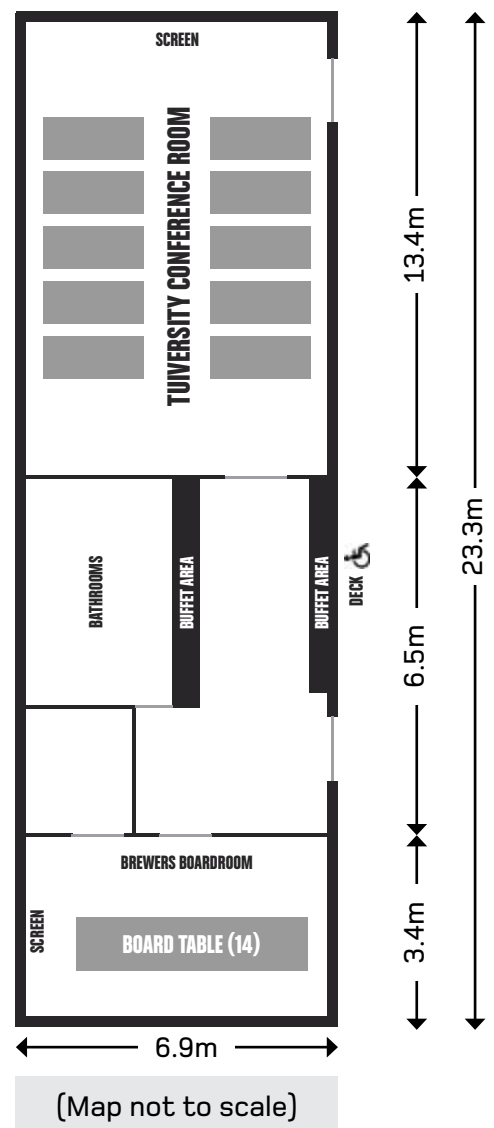
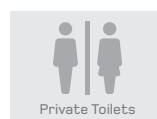



BREAKOUT ACTIVITIES



At Tui Brewery

We offer a range of unique onsite activities which create lasting memories for you and your colleagues and friends. These include:

Brewery Tours

Experience a personalised 35-minute tour through the new, state of the art Brewhouse and learn about the art of brewing. Our Experience Ambassadors will walk you through our 129-year long history of brewing on this site in Mangatainoka and explain the changes in the brewing process – from gravity fed brewing inside the iconic Tui Brewery Tower, to the importance of consistency and control in the state of the art equipment we use today. You can see, smell and taste the various elements, and meet the head brewer himself. Tours run daily 11:30am and 2:30pm. Tours for groups over 15 people can be arranged at separate times.

Private Tour options available for conference room bookings

Keg Pong Tournaments

Tui invented this game. Get outside in our garden bar and battle your mates in this fun, over dramatised game. Max 10 people at a time.

Closest To The Pin Golf Challenge

As they say in golf... "it's all in the swing"... and this game is no exception. Challenge your friends to see who is the most accurate in trying to putt the ball closest to the pin. This fun game is a great, quick break out activity. Land it in the keg for a bonus prize.

Design Your Own Team-Building Activity

Our large village green and garden bar is a perfect location for your own team building exercise, whether it be water relays, trust falls, problem solving, creating your own Tui billboard or giant slingshots – we have the space!

Be Inspired By Nick Rogers Guest-Speaker

Nick Rogers oversaw the development of Tui HQ from a 'hole-in-the-wall bottle shop with a brewery out the back', to a national icon and unique destination. Hear his story which is full of entertaining and insightful tales about the Tui brand, the Tui Brewery and the future of beer in New Zealand. Nick has 10 years of public speaking experience, is nationally renowned as an innovative marketer, can motivate people and give them something to smile about.

Plants & Pints Project

Join us on our quest to protect the Mangatainoka Reserve and riverside, by getting involved in our Plants & Pints Project. So far we have planted over 1,500 plants, in a bid to improve water quality and to beautify this small township. We will donate the native plants from our onsite nursery and the spades, and your team can plant a native tree each on the riverside*. When you return we will shout you all a drink. We appreciate donations towards this important initiative.

*Conditions apply.



Prices vary on group size for all activities



In the Area

Bubble Ball

This is all about having fun! Enjoy a game of bubble ball in miniature zorbs. Roll around our village green and challenge your colleagues.

www.bubbleball.co.nz

Amalgamated Helicopters Rides

Take off from the Wairarapa and fly over stunning rolling farm land with views of the Tararua ranges to the tiny township of Mangatianoka. See Tui Brewery from above and be impressed with a landing right beside the newly refurbished Tui Tower. Other scenic flights to nearby Manawatu and Hawke's Bay can also be arranged.

www.amalgamatedheli.co.nz

Golf

Enjoy 9 holes of golf at the nearby Pahiatua Golf Course, which is surrounded by rolling farmland before reflecting on your game back at Tui Brewery with a cold one on us.

Pukaha Mount Bruce National Wildlife Centre

Experience New Zealand's rare and endangered wildlife up close in a beautiful setting at Pukaha Mount Bruce National Wildlife Centre located 30 mins drive south of Tui. See Manukura, the white kiwi, feed the eels and watch the Kaka circus.

www.pukaha.org.nz

BREAKOUT ACTIVITIES



BREWER & VINTNER



Group Experience

This wine, food and beer match is like no other – in fact you could say, it's the perfect food and drink experience. Held on site in Tui Brewery, the Brewer & Vintner Experience is designed to give visitors a taste of what goes into producing our famous Tui beers and some of Wairarapa's leading wines all the while matching these to our tasting plates ... lifting your food to a new level.

Tui's head brewer Tupu will share his insights with you by taking you through a personalised tasting of four beers, which are matched with four tasting plates. Then, the vintner from Loopline Vineyard, in the wine growing region of Opaki, in the Wairarapa will take you through a wine tasting, with each glass matched to our tasting plates. This is a must do for beer and wine aficionados who can debate which variety comes up trumps.

Package Includes

Coach transport from Masterton or Palmerston, tasting of 4 Tui beers and 4 Loopline wines, all matched with food.

\$135 Per person (minimum of 40 people)
terms & conditions apply

Allow two hours to fully enjoy this package.



CATERING OPTIONS

Here at Tui Brewery our café offers wholesome kiwiana inspired meals seven days a week. From fresh salads and seafood dishes to warm soups and steak sammies, you are sure to be satisfied.

Catering options are available on request, and change to suit the seasons, as well as all budgets and dietary requirements. You can pick from one of our convenient package meals designed to work for any style of conference or private function, or we can design a menu to work for you.

See our restaurant menu and latest conference offerings at tuihq.co.nz



EXTRAS

TO MAKE YOUR CONFERENCE, EVENT OR FUNCTION EASIER

We are proudly located in a rural environment but offer all the mod-cons you'd expect in the Big Smoke.

These include additional requirements (all our standard prices are including GST)

Your room hire may already include some of the following items:



\$50

MICROPHONE



\$70

PROJECTOR



\$50

WHITE BOARD + PENS



\$25PP

35 MINUTE
BREWERY TOUR



\$1500

GUEST SPEAKER – NICK
ROGERS, TUI BREWERY
EXPERIENCE DIRECTOR



FROM
\$600

1 PIECE COVER BAND



FROM
\$1100

3 PIECE COVER BAND

CORPORATE GIFTS

TUI PAD +PEN	\$12.00
TUI GLASS	\$10.00
PERSONALISED TUI BEER BOTTLE	\$12.50
TUI GLASS, PAD & PEN COMBO	\$20.00



**GROUPS OVER 20 GUESTS RECEIVE 10% OFF AT THE TUI RETAIL SHOP.
ALL PRICES ARE SUBJECT TO CHANGE.**

GETTING HERE

Mangatainoka is a small settlement in the Tararua region, located on the banks of the Mangatainoka River. The Tui Brewery is positioned on the northern side of the village on State Highway 2, and can be easily identified by the iconic Tui Brewery Tower, a Heritage 1 building built in 1931.

The recommended driving route from Palmerston North is via the Saddle Road to Woodville and then south from there along State Highway 2 to Mangatainoka. From Masterton it is approximately a 50 minute drive north along SH2.

Direct Flight Times to Palmerston North

Auckland	1 hour
Wellington	35 mins
Christchurch	1 hr 10 mins
Hamilton	50 mins

Drive Times to Tui Brewery

Palmerston North	42 mins
Masterton	50mins
Taupo	3 hours 20 mins
Wellington	2 hours 10 mins
New Plymouth	3 hours 24 mins
Wanganui	1 hour 35 mins
Napier	2 hours

Accommodation

In Wairarapa we recommend visiting www.wairarapanz.com for a wide range of accommodation options including from luxury lodge to four star accommodation and charming cottages. We regularly partner with the 4 star, Qualmarked Copthorne Solway Park, which is set in 10 hectares of landscaped gardens in Masterton. www.millenniumhotels.co.nz/copthornewairarapa

In Palmerston North we recommend visiting www.manawatunz.co.nz to book a wide range of accommodation or Hotel Coachman, nestled in the heart of town. It is the city's only 4 plus star qualmark rated accommodation provider. 0800 800 678 or www.coachman.co.nz.

Accommodation for out of town guests can be arranged or made direct through the hotels or motels. Nearby in Mangatainoka there is Masters Hall at 7 Regent St, Pahiatua. Ph: 06 3766 552 or www.mastershall.co.nz.

Motorhomes

Parking for motorhomes is available at Mangatainoka Reserve and onsite at Tui Brewery.

This makes for a unique accommodation option.



Transport

We have a great partnership with Tranzit. To discuss any transport options please call 0800 471 227 or visit www.tranzit.co.nz. Quote "Tui HQ" to get a good deal.

Return Tranzit Coaches
from Palmerston North
and Masterton

tranzit
coachlines
Tranzit.co.nz





www.tuihq.co.nz
hospo@tuihq.co.nz
06 376 0815



Tui Brewery
State Highway 2
Mangatainoka